



SR-23 Series

ROCKER SWITCH



SR-23A



SR-23C

Specification:

3(1)A	250VAC	T105
10(4)A	250VAC	T105
16(6)A	250VAC	T105

5E4



3A	250VAC	T105
6A	125VAC	T105
10A	250VAC	T105
16A	125VAC	T105
1/2HP	250VAC	T105
1/4HP	125VAC	T105

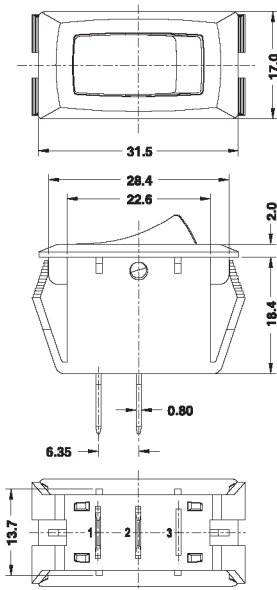

Suggested panel hole size

Panel thickness	x
0.8-2.0	28.8



SR-23

Function	Current	Terminal Type	Base Color	Button Color	Base Type	Button Type	Printing	Color of Printing	Internal Use Only
A ON-OFF	S 3(1)A 250VAC		BK Black	BK Black			0 None	0 None	
C ON-OFF-ON	6A 125VAC		WT White	WT White			1 1	1	1 White
L	16(6)A 250VAC		GE Grey	GE Grey			2	2 Black	
	10(4)A 250VAC 5E4		RE Red	RE Red			3	3 Red	
	16A 125VAC		GR Green	GR Green			4	4 Blue	
	1/2HP 250VAC		BL Blue	BL Blue			5	5 Yellow	
	1/4HP 125VAC		OR Orange	OR Orange			6		
			YE Yellow	YE Yellow			7		
							8		
			9						
			A						